



# Go-with-Me ABC Backpack™



## Parent's Guide

This guide contains important information. Please keep it for future reference.

# INTRODUCTION

Thank you for purchasing the **Go-with-Me ABC Backpack™!** Pack your bag and get ready to have a blast learning letters, writing and drawing with Mr. Pencil.

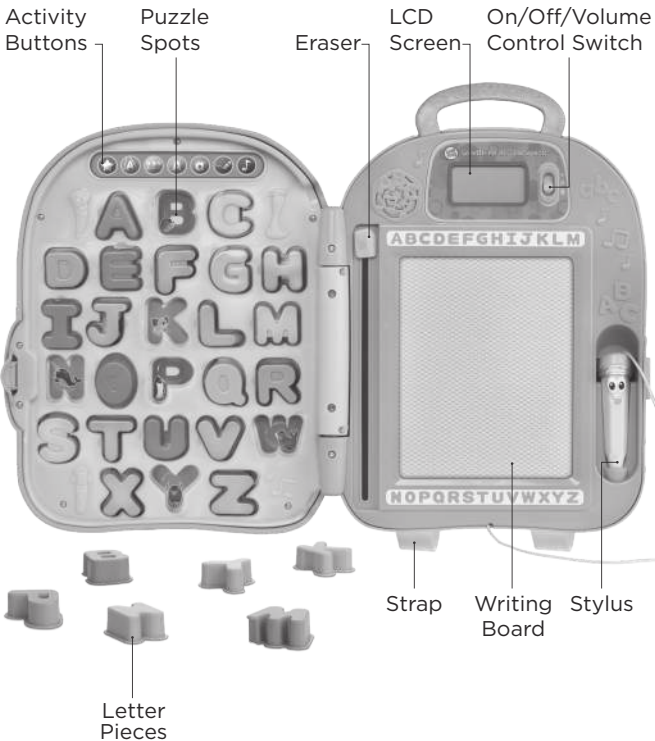

# INCLUDED IN THIS PACKAGE

- One **Go-with-Me ABC Backpack™**
- 26 letter pieces
- Two backpack straps
- One parent's guide

## **WARNING:**

All packing materials, such as tape, plastic sheets, packaging locks, removable tags, cable ties and packaging screws are not part of this toy, and should be discarded for your child's safety.

## **NOTE:**

Please keep this parent's guide as it contains important information.

## **ATTENTION :**

Pour la sécurité de votre enfant, débarrassez-vous de tous les produits d'emballage tels que rubans adhésifs, feuilles de plastique, attaches, étiquettes et vis d'emballage. Ils ne font pas partie du jouet.

## **NOTE :**

Il est conseillé de conserver ce guide des parents car il comporte des informations importantes.

## **Unlock the packaging locks:**

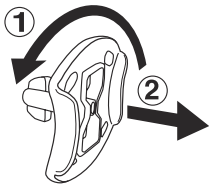

- ① Rotate the packaging locks 90 degrees counterclockwise.
- ② Pull out the packaging locks and discard.

# GETTING STARTED

## BATTERY INSTALLATION

1. Make sure the unit is turned **OFF**.
2. Locate the battery cover on the bottom of the unit.
3. Use a screwdriver or a coin to loosen the screw and open the battery cover.
4. Install 2 new AA (AM-3/LR6) batteries into the battery box as illustrated. (The use of new alkaline batteries is recommended for maximum performance.)
5. Replace the battery cover and tighten the screw to secure.

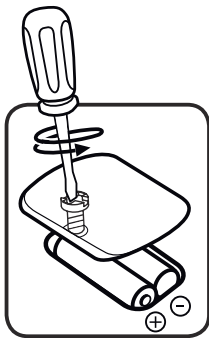

## BATTERY NOTICE

- Use new alkaline batteries for maximum performance.
- Use only batteries of the same or equivalent type as recommended.
- Do not mix different types of batteries: alkaline, standard (carbon-zinc) or rechargeable, or new and used batteries.
- Do not use damaged batteries.
- Insert batteries with the correct polarity.
- Do not short-circuit the battery terminals.
- Remove exhausted batteries from the toy.
- Remove batteries during long periods of non-use.
- Do not dispose of batteries in fire.
- Do not charge non-rechargeable batteries.
- Remove rechargeable batteries from the toy before charging (if removable).
- Rechargeable batteries are only to be charged under adult supervision.

## MISE EN GARDE

Les piles fournies avec le produit permettent de tester le jouet en magasin mais ne sont pas des piles longue durée.

- Seules des piles du type recommandé doivent être utilisées.
- Ne pas mélanger différents types de piles ou d'accumulateurs, ne pas mélanger des piles ou des accumulateurs neufs avec des usagés.
- Ne pas utiliser des piles ou des accumulateurs endommagés.
- Mettre en place les piles ou les accumulateurs en respectant les polarités + et -.
- Ne pas mettre les bornes d'une pile ou d'un accumulateur en court-circuit (en reliant directement le + et le -).
- Enlever les piles ou les accumulateurs usagés du jouet.
- Retirer les piles ou les accumulateurs en cas de non-utilisation prolongée.
- Ne les jeter ni au feu ni dans la nature.
- Ne pas tenter de recharger des piles non rechargeables.
- Enlever les accumulateurs du jouet pour les recharger.
- Les accumulateurs ne doivent être chargés que sous la surveillance d'un adulte.

# ASSEMBLY INSTRUCTIONS

The **Go-with-Me ABC Backpack™** comes with backpack straps that can be attached or removed at any time. Follow the steps below to attach these straps:

**NOTE: Adult operation needed.**

1. Insert one end of the strap through the slot on the top and the other end through the slot on the bottom.

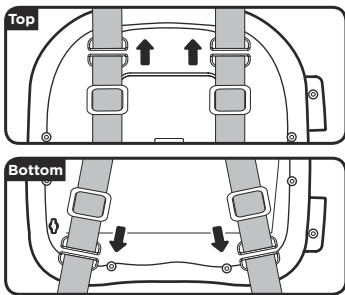

2. Loop the strap through the buckle. Secure both ends of the strap as shown. Repeat for the second strap.

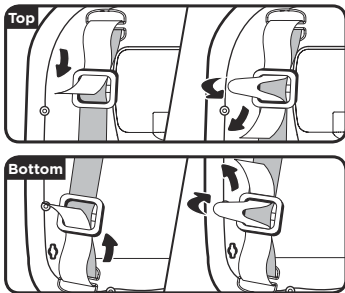

# PRODUCT FEATURES

## 1. On/Off/Volume Control Switch



Slide the **On/Off/Volume Control Switch** to turn the toy on and select the volume.

## 2. LCD screen

The **LCD Screen** displays letters, letter stroke order and fun animations.



## 3. Activity Buttons

Press the **Activity Buttons** to select an activity.



## 4. Letters & Puzzle Spots

Press the **Letter Pieces** into their **Puzzle Spots** to trigger fun audio.



## 5. Stylus, Writing Board & Eraser

Use the **Stylus** to draw on the **Writing Board**. Slide the **Eraser** up and down to clear the board.



**NOTE:** For best results, write slowly on the **Writing Board** using the **Stylus**. Clean the writing by sliding the **Eraser** slowly several times.

## 6. Backpack Straps

Attach the **Straps** to carry just like a backpack.



## 7. Low Battery Indicator

When the batteries run low, this icon  will appear on the screen, flash twice and the unit will power off. Remove the old batteries and replace with a new set.



# ACTIVITIES

## 1. Letter Zoo



Press a **Letter Piece** into its **Puzzle Spot** to hear the letter name, letter sound and an animal that begins with that letter.

## 2. Meet the Letters



Listen to the letter names, then try to find them in this silly game.

## 3. Mystery Word



Listen to the letter sounds, then try to find the correct letters. Fill in the blanks to sound out the mystery word.

## 4. Uppercase Letters



Follow the animations to learn how to write uppercase letters using the **Stylus** and **Writing Board**.



## 5. Lowercase Letters



Follow the animations to learn how to write lowercase letters using the **Stylus** and **Writing Board**.

## 6. Letter Animals



Follow the animations to learn how to turn letters into animals using the **Stylus** and **Writing Board**.

## 7. Music



Press a **Letter Piece** into its **Puzzle Spot** to hear the Letter Parade song.

# CARE & MAINTENANCE

1. Keep the unit clean by wiping it with a slightly damp cloth.
2. Keep the unit out of direct sunlight and away from any direct heat sources.
3. Remove the batteries when the unit is not in use for an extended period of time.
4. Do not drop the unit on a hard surface and do not expose the unit to excess moisture.

# TROUBLESHOOTING

If for some reason the program/activity stops working, please follow these steps:

1. Turn the unit **OFF**.
2. Interrupt the power supply by removing the batteries.
3. Let the unit stand for a few minutes, then replace the batteries.
4. Turn the unit back **ON**. The unit will now be ready to play again.
5. If the unit still does not work, replace with an entire set of new batteries.

## **IMPORTANT NOTE:**

If the problem persists, please call our Consumer Services Department at **1-800-701-5327** in the U.S. or email [support@leapfrog.com](mailto:support@leapfrog.com). Creating and developing LeapFrog® products is accompanied by a responsibility that we take very seriously. We make every effort to ensure the accuracy of the information, which forms the value of our products. However, errors sometimes can occur. It is important for you to know that we stand behind our products and encourage you to contact us with any problems and/or suggestions you might have. A service representative will be happy to help you.

## Environmental phenomena.

The unit may malfunction if subjected to radio-frequency interference. It should revert to normal operation when the interference stops. If not, it may become necessary to turn the power **OFF** and back **ON**, or remove and reinstall the batteries. In the unlikely event of an electrostatic discharge, the unit may malfunction and lose memory, requiring the user to reset the device by removing and reinstalling the batteries.

## Impact de l'environnement.

Une défaillance de fonctionnement de l'appareil peut survenir s'il est sujet à des interférences avec les fréquences radioélectriques. Le fonctionnement normal de l'appareil devrait reprendre avec l'arrêt des interférences. Si ce n'est pas le cas, il peut s'avérer nécessaire d'éteindre et rallumer l'appareil ou de retirer et réinstaller les piles. Dans l'éventualité peu probable d'une décharge électrostatique, un mauvais fonctionnement et une perte de mémoire de l'appareil peuvent se produire. L'utilisateur doit alors retirer et réinstaller les piles pour réinitialiser l'appareil.

### **Supplier's Declaration of Conformity**

Trade Name:	Leapfrog®
Model:	6034
Responsible Party:	LeapFrog Enterprises, Inc.
Address:	6401 Hollis Street, Suite 100, Emeryville, CA 94608
Website:	<a href="http://www.leapfrog.com">www.leapfrog.com</a>

## NOTE:

This equipment has been tested and found to comply with the limits for a Class B digital device, pursuant to Part 15 of the FCC Rules. These limits are designed to provide reasonable protection against harmful interference in a residential installation. This equipment generates, uses and can radiate radio frequency energy and, if not installed and used in accordance with the instructions, may cause harmful interference to radio communications. However, there is no guarantee that interference will not occur in a particular installation. If this equipment does cause harmful interference to radio or television reception, which can be determined by turning the equipment off and on, the user is encouraged to try to correct the interference by one or more of the following measures:

- Reorient or relocate the receiving antenna.
- Increase the separation between the equipment and receiver.
- Connect the equipment into an outlet on a circuit different from that to which the receiver is connected.
- Consult the dealer or an experienced radio/TV technician for help.

**Caution:** Changes or modifications not expressly approved by the party responsible for compliance could void the user's authority to operate the equipment.

THIS DEVICE COMPLIES WITH PART 15 OF THE FCC RULES. OPERATION IS SUBJECT TO THE FOLLOWING TWO CONDITIONS: (1) THIS DEVICE MAY NOT CAUSE HARMFUL INTERFERENCE, AND (2) THIS DEVICE MUST ACCEPT ANY INTERFERENCE RECEIVED, INCLUDING INTERFERENCE THAT MAY CAUSE UNDESIRE OPERATION.  
*CAN ICES-3 (B)/NMB-3(B)*



## **WARNING:**

CHOKING HAZARD—small parts.  
Not for children under 3 yrs.



## **ATTENTION:**

Danger d'étouffement — petits  
éléments. Ne convient pas aux  
enfants de moins de 3 ans.



***Visit our website for more  
information about our products,  
downloads, resources and more.***

***leapfrog.com***

***Read our complete warranty policy online  
at [leapfrog.com/warranty](http://leapfrog.com/warranty).***

LeapFrog Enterprises, Inc.,  
a subsidiary of VTech Holdings Limited.  
TM & © 2018 LeapFrog Enterprises, Inc.  
All rights reserved.  
91-003510-005<sup>US</sup>